

PISARA

Side Cabinets installation and care guide

BEFORE YOU START	P. 02
INSTALLATION	P. 03
CARE AND MAINTENANCE	P. 07
DIMENSION IMAGES	P. 07

Ennen kuin aloitat

Please ensure the following before installation

Read through the installation guide carefully.

Side cabinet installation includes the installation of the fixture without plumbing or electrical installation.

Check the bearing capacity of the wall.

If you are unsure about installing the fixtures, please hire a professional installer. All the electrical connections must be installed by professionals. Make sure that mounting fixtures to the wall does not damage the wiring or plumbing inside the wall.

What you need for installation

- Utility knife or scissors
- Measuring tape
- Spirit level
- Cross-head (Phillips) screwdriver for adjusting the doors
- Drill machine (if wall plugs are required for proper mounting)
- with percussion (if the fixture is mounted to a brick or concrete wall)
- Battery machine
 - Bits that fit the screws
 - Bit for the pilot hole for mounting the fixture
- Caulking gun
- Vacuum cleaner

What you need for mounting

- Appropriate screws and washers that fit them for mounting the fixture
- Wall plugs (if required for proper mounting)
- Sanitary silicone, colourless or matching the fixture

Side Cabinet installation and care guide

Installation

1. Open the package.
 - A Use a utility knife or scissors.
 - B Make sure the blade does not hit the fixture.
 - C Place the fixture on top of packing cardboard or some other protective surface.
2. Check the fixture for possible transport damage or factory defects.
 - A If you notice something, report it to the seller before installing the fixture. **Note! Do not install a damaged fixture.**
3. Remove the door
 - A Support the door during its removal.
 - B Remove the hinges starting from the bottom, removing the top hinge last.
 - B1 The hinge comes off when you pull the lever at the rear end of the hinge arm away from the frame.
 - C Lower the door on a protective cover and leave it to the side to wait.
4. If you ordered legs for the fixture, attach them at this point.
 - A Legs must be installed for L depths.
 - B Legs are not required for S depths, provided that the wall material and the mounting parts do not require them.
 - C Attach both front legs to the fixture (centre of the leg max. 1/3 of the total depth of the fixture from the front edge of the frame).
 - D No legs are needed at the back of the fixture, because the fixture must always be securely mounted to the wall.
 - E Adjust the legs to the desired height.



Installation



5. Drill pilot holes in the desired locations in the back binder lath of the fixture.

- A You need at least four pilot holes, one near each corner.
- B **Tip:** The pilot hole should be 1-2 mm bigger than the diameter of the screw (but so that the washer easily covers the hole) so that the fixture can be easily adjusted.

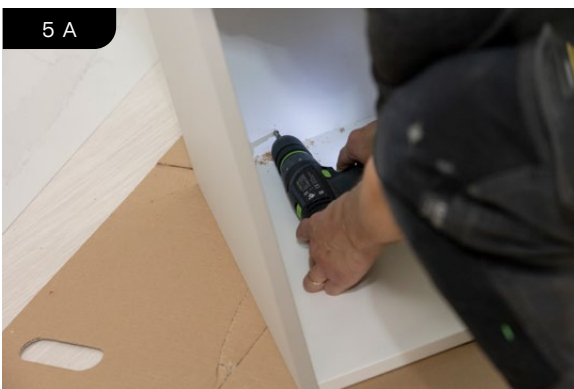

6. Measure the place where you want the cabinet to stand.

- A Mark the locations for the pilot holes on the wall.
- B Leave enough room for the door to open without hitting any other structures and make sure there is enough room for possible baskets to be taken out.
- C **Tip:** Measure the gap between the floor and the bottom panel so that it is the same size as in the vanity. This will create a coherent look.



Installation

7. Mount the fixture to the wall through the pilot holes.

- A If wall plugs are required for proper mounting, drill the holes you need in the wall where you have marked the pilot holes and install wall plugs.
 - A1 Move the fixture to a safe place while drilling.
 - A2 **Tip:** To ensure a neat outcome, use a vacuum cleaner while drilling and finish off by vacuuming the hole you have drilled.
- B If necessary, support the fixture from below to make it easier to mount.
- C Use a spirit level to make sure the fixture is level and adjust if necessary.



8. Clean up after the installation and remove any drill dust.



9. Install the shelves.

- A Place the shelf supports in the desired height, 4 supports per shelf.
- B Holding the shelf horizontal, first lower one side on top of the supports and then the other.



Side Cabinet installation and care guide

Installation

10. Install the door.

- A Support the door during the installation.
- B Install the hinges starting from the top, installing the bottom hinge last.
 - B1 Install the hinge by first pushing the front end of the hinge arm onto the backplate, then the rear end, until you hear a click.
- C Check to make sure the door works.

11. Check the position of the door and adjust, if necessary.

- A Height adjustment
 - A1 Loosen the tightening screws in the backplates of the hinges so that the backplates can move, but are not completely loose.
 - A2 Adjust the height by lifting or lowering the door.
 - A3 Tighten the tightening screws.
- B Side adjustment
 - B1 Adjust the lateral position of the door using the frontmost screw of the hinge arms.
- C Depth adjustment
 - C1 Adjust the depth of the door using the rearmost screw of the hinge arms.
- D Soft-close
 - D1 Adjust the soft-close mechanism using the small grey lever located at the bottom of the hinge cup. (Soft-close is turned on when the lever is pushed back and off when it is pulled forward).
- E **Tip:** The hinge we use is Blum Expando Blumotion with integrated soft-close.

12. If you have ordered pulls, measure and install them.

- A Pull screws come with the pulls.
- B Pulls are attached from the back of the front panel.
- C Measure the position of the pull and mark the fixing points through the holes of the pull.
- D Drill pilot holes with a diameter of 2 mm and take care not to drill through the door.

13. Finish off by cleaning the fixture and removing any stains according to the care instructions.

Congratulations, your installation is now complete!

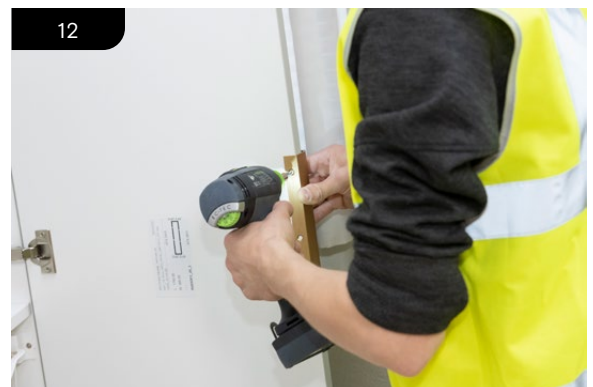
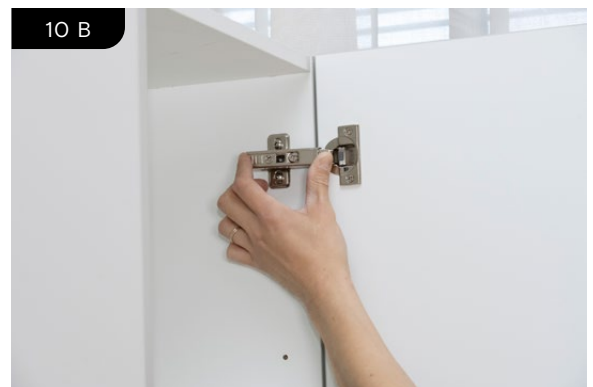

Care & maintenance

- 1. Cleaning the fixture**
 - A The fixture and the basin are cleaned using a mild household cleaning agent.
 - B They can be cleaned with a slightly damp towel or a microfibre cloth.
- 2. Instructions for removing stains**
 - A Any stains on the fixture or the basin should be removed preferably using a household cleaning agent. Remove any stains as soon as you discover them.
 - B If the stain cannot be removed with a stain remover, you can use white spirit (turpentine).
 - B1 If you do use white spirit, clean the spot afterwards with a cleaning agent.
 - B2 Using acetone to remove stains from the fixture is prohibited.
 - C Stains can be removed using a microfibre cloth or a sponge.
- 3. The fixture does not require any special maintenance apart from cleaning.**

Dimension images

Please download dimension drawings / images from pisarafinland.fi.

Customer service > Documentation

FOR MORE INFORMATION:

pisarafinland.fi